

FED. DIST. NO.	STATE	N.R.S. PROJ. NO.	FISCAL YEAR	SHEET NO.	TOTAL SHEETS
6	ARK.	NR5303A	1934	1	13

State Job No. 1-1072

STATE OF ARKANSAS
STATE HIGHWAY COMMISSION

PLAN OF PROPOSED BRIDGES
HICKORY RIDGE-CHERRY VALLEY ROAD
CROSS COUNTY
ROUTE 42 SEC. 2
JOB NO. 1-1072
U. S. PUBLIC WORKS PROJECT NO. N.R.S. 303A

Limits of Project: Ends of bridges as shown below.

		QUANTITIES		Unit	Bridges	Road	Total for Job 1-1072
Item No.							
12	Common Excavation	Cu.Yds.	286		286		286
13	Dry Excavation for Structures	Cu.Yds.	40		20		40
91	Class 5 Concrete for Bridges	Cu.Yds.	405.67				405.67
92	Reinforcing Steel for Bridges	Lbs.	89,751				89,751
94	Concrete Railing for Bridges	Lin. Ft.	1526				1526
96	Structural Steel in Beam Spans	Lbs.	253,676		436		253,676
97	Treated Bridge Timber	M.F.B.M.	16,490				16,490
97	Untreated Bridge Timber (Cypress)	M.F.B.M.	8,051		1208		8,051
98	Treated Timber Piling	Lin. Ft.	5228				5228
98	Treated Timber Piling Cutoff	Lin. Ft.	396				396
98	Untreated Timber Piling (Cypress)	Lin. Ft.	312				312
98	Timber Test Piles	Each	7				7
SP	Bronze State Bridge Name Plates	Each	14				14
SP	Repairs to Present Bridges	Lump Sum			Lump Sum	Lump Sum	Lump Sum

INDEX OF SHEETS			
Sheet No.	Drawing No.	Title Sheet	
2	3571	Layout of Bridge No. 1807	
3	3572	" " " " " " " "	
4	3573	" " " " " " " "	
5	3574	" " " " " " " "	
6	3575	" " " " " " " "	
7	3576	" " " " " " " "	
8	3577	" " " " " " " "	
9	3578	Details of Bridge No. 1807	
10	3579	" " " " " " " "	
11	2145	Details of 27'-0" Standard I-Beam Span	
12	2150	" " " " " " " "	
13	2386	" " Bridge Name Plates	

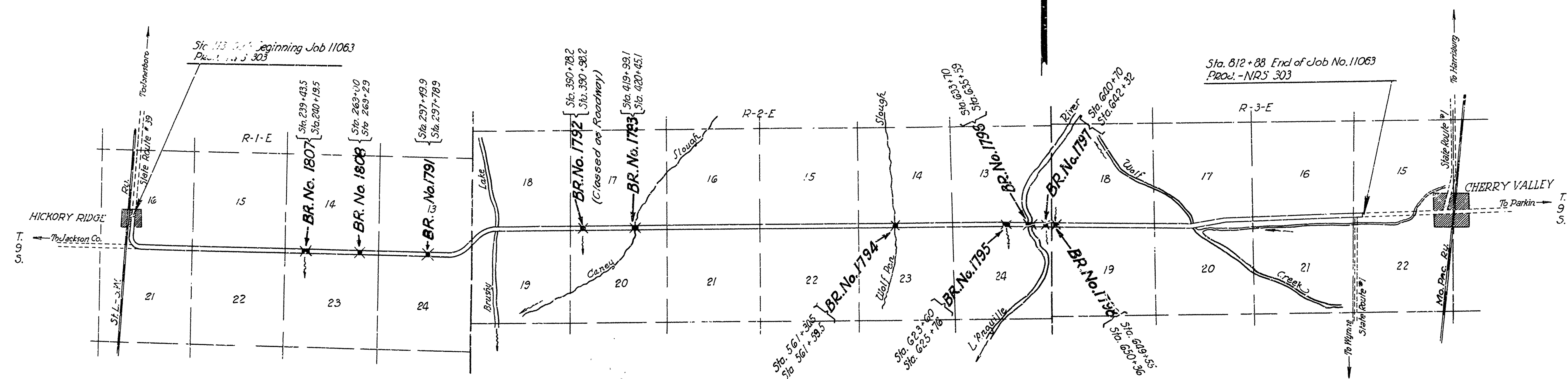

Note: Road and grading to be constructed under State Job No. 1-1063

Specifications approved by Chief, Bureau of Public Roads, September 28, 1925, and adopted by State Highway Commission May 30, 1925 with revisions and Special Provisions as follows:

REVISIONS	
Pamphlet A	Revised Mar. 1st, 1931 Approved June 13th, 1931
B	Revised Nov. 1st, 1927
C	Revised July 1st, 1923 Approved Nov. 24th, 1928
D	Revised Jan. 1st, 1930
E	Revised Aug. 1st, 1928
F	Revised June 1st, 1932
G	Revised Jan. 1st, 1930
H	Revised Jan. 1st, 1930
I	Revised Jan. 1st, 1929 Approved June 1st, 1929
J	Revised Feb. 10th, 1933 Approved
K	Mar. 1st, 1931 June 13th, 1931
L	Oct. 1st, 1932
M	Oct. 1st, 1933
N	Oct. 1st, 1933
Labor (12 Sheets) Approved Oct. 13th, 1933	

SPECIAL PROVISIONS		
Item	No. of Sheets	Date
Map Scale	1	
Repairs to Present Bridges	1	11-17-33
Bronze Project Marker Plates & Bronze State Bridge Nameplates	1	8-10-33
Labor Preference	1	11-23-33

LAYOUT
Scale: 1" = 3000'

LENGTH OF PROJECT	= 877 Lin. Ft. = 0.165 Mi.
LENGTH OF BRIDGES	= 857 Lin. Ft. = 0.162 Mi.
LENGTH OF ROADWAY	= 20 Lin. Ft. = 0.003 Mi.
LENGTH OF JOB	= 877 Lin. Ft. = 0.165 Mi.

REVISIONS
Quantities Reclassified Dec. 18, 1933. B.V.

APPROVED	
CHIEF ENGINEER - U. S. BUREAU OF PUBLIC ROADS	
APPROVED	
DISTRICT ENGINEER - U. S. BUREAU OF PUBLIC ROADS	
APPROVED	
CHIEF - U. S. BUREAU OF PUBLIC ROADS	
APPROVED	
CHIEF - STATE HIGHWAY COMMISSION	
APPROVED	
STATE HIGHWAY ENGINEER	

N.B. Lamm
BRIDGE ENGINEER

1807, 1808,
BRIDGES No. 1791-92-93-94-95-96-97-98 DRAWING NO. 3571